



2 Vine Cottages, Handley Street, Ebbesbourne Wake, Salisbury, Wiltshire, SP5 5JG

£1,100 PCM

A charming 2 bed extended semi-detached thatched cottage in centre of popular Chalke Valley village.

Accommodation comprises: reception hall with utility area, cloakroom/wc, kitchen/breakfast room, electric oven, ceramic hob, integral dishwasher and full range of fitted units with down lighting, The AGA shown in the photos is non functioning. Living room with vaulted ceiling and french doors to garden. Two double bedrooms and bathroom with electric shower over bath. Enclosed rear garden, mainly grass with terrace, shed and lovely views towards chalk downland beyond. Graveled parking for several cars. New electric heating, Unfurnished with new carpets and freshly painted.

Ground Floor

Approx. 86.2 sq. metres (928.2 sq. feet)

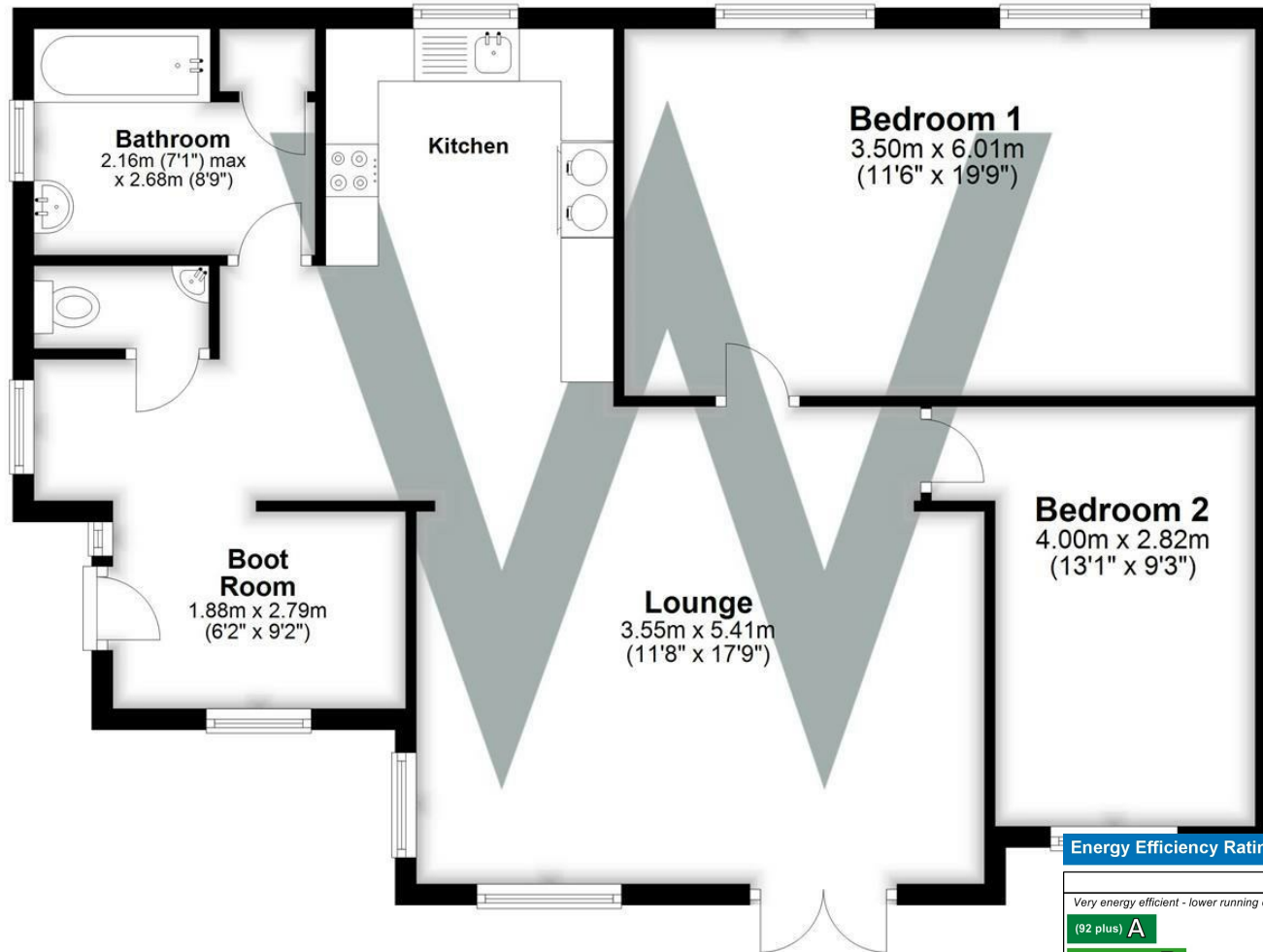

Total area: approx. 86.2 sq. metres (928.2 sq. feet)



Energy Efficiency Rating

	Current	Potential
Very energy efficient - lower running costs		
(92 plus) A		88
(81-91) B		
(69-80) C		
(55-68) D	55	
(39-54) E		
(21-38) F		
(1-20) G		
Not energy efficient - higher running costs		
England & Wales	EU Directive 2002/91/EC	

WHITES
Castle Chambers, 47 Castle Street,
Salisbury, Wiltshire, SP1 3SP
01722 336422
www.hwwhite.co.uk
residential-sales@hwwhite.co.uk

